

Multi-Angle Work Holder Assembly Instructions

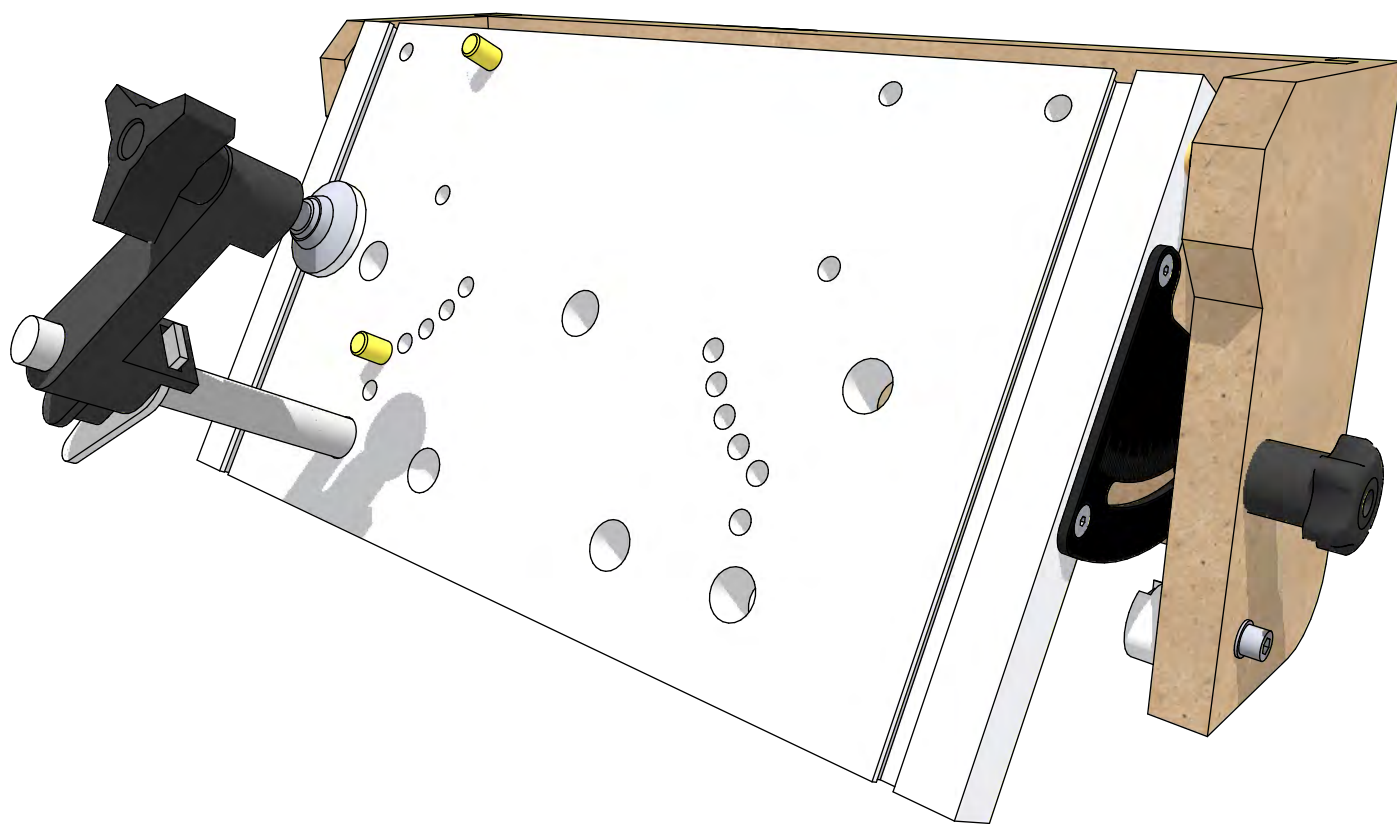

Multi-Angle Work Holder

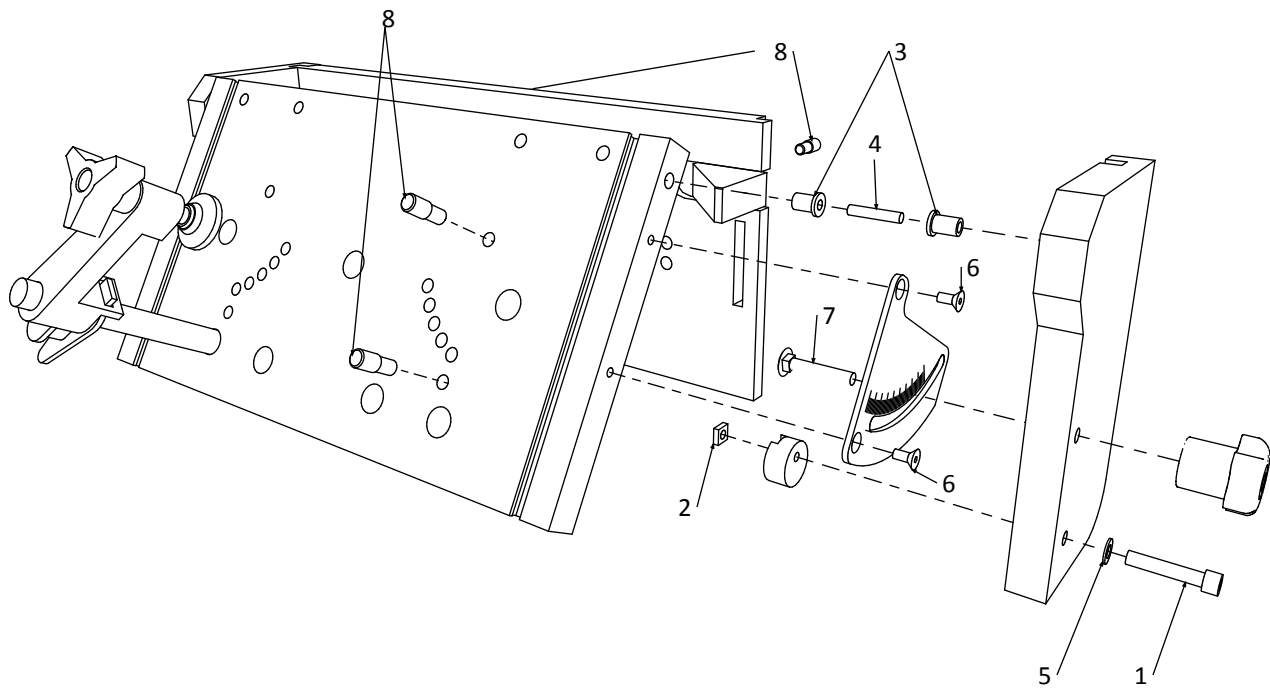

Content of Router Boss Multi-angle Work Holder Kit Fastener Bag

1	2	10-24 x 1-1/4" Socket Head Screw	Attach cam stops to box sides
2	2	10-24 Square Nut	Nut with socket screw above
3	4	Flanged Bearing for 3/16" Shaft, 5/16" OD	Pivot bearing in alum angle plate & box sides
4	2	3/16" Dowel Pin, 1" Length	Shaft in above flanged bearings
5	2	#10 Flat Washer 0.200" ID, 0.450" OD	Washer on above socket head screws
6	4	#8-32 x 3/8" Flat Socket Head Screw	Attach angle bracket (protractor) to angle plate
7	2	1/4-20 x 1-1/2" Carriage Bolt	Slide in angle brackets and attach to box sides
8	4	5/16" Plastic Locator Pins	Position work holder on sliding bar & board on plate



Multi-Angle Work Holder

Assembly Instructions

- Attach protractors to the ends of the aluminum plate as shown at left using the four 8-32x3/8" flat head socket screws.
- Press a flanged bearing into the larger hole on each end of the aluminum plate.
- Insert a dowel pin into the flanged bearings.
- Insert flanged bearing into the holes in the MDF side plates.
- Dry assemble aluminum plate and MDF sides, back and corner blocks together to test for fit then glue the assembly together.
- Install the carriage bolts through slot in the protractors and through the middle holes in the side plates.
- On outside of the work holder attach the knobs to the carriage bolts. Tighten the knobs to help clamp up the assembly.
- Clamp the corner pieces as shown below to draw the assembly square. A Quick Grip type clamp can be used for this. Check for squareness.
- When the glue has dried install the cam stops with the 10-24x1-1/4" socket head screws, the #10 flat washers and the 10-24 square nuts.

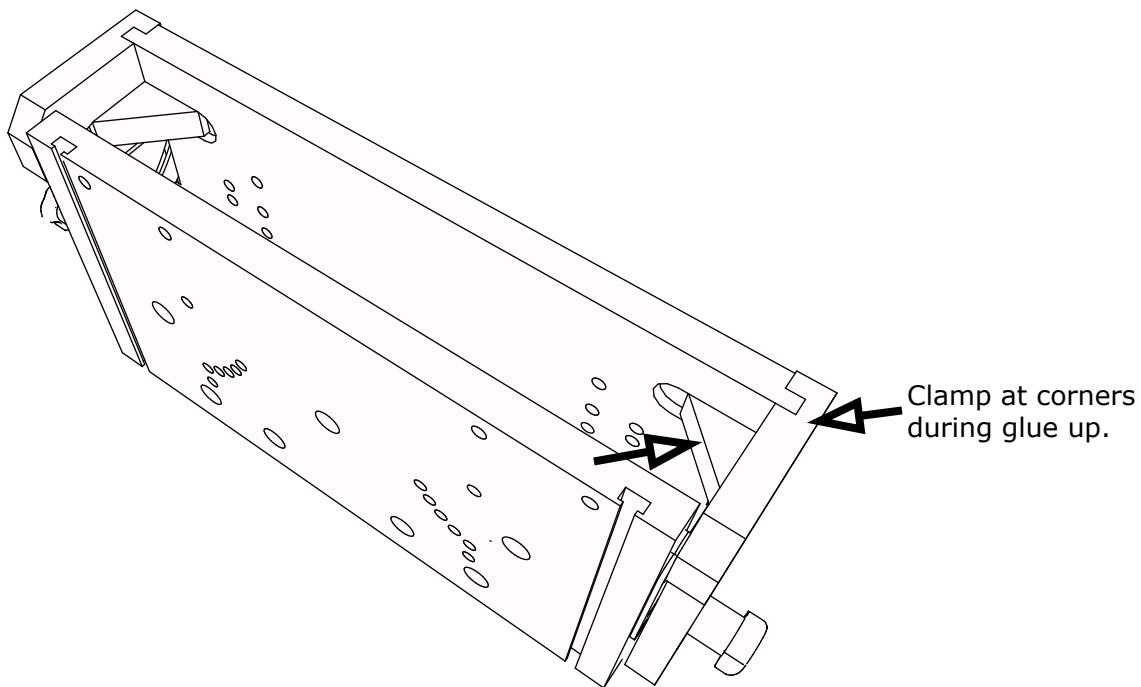
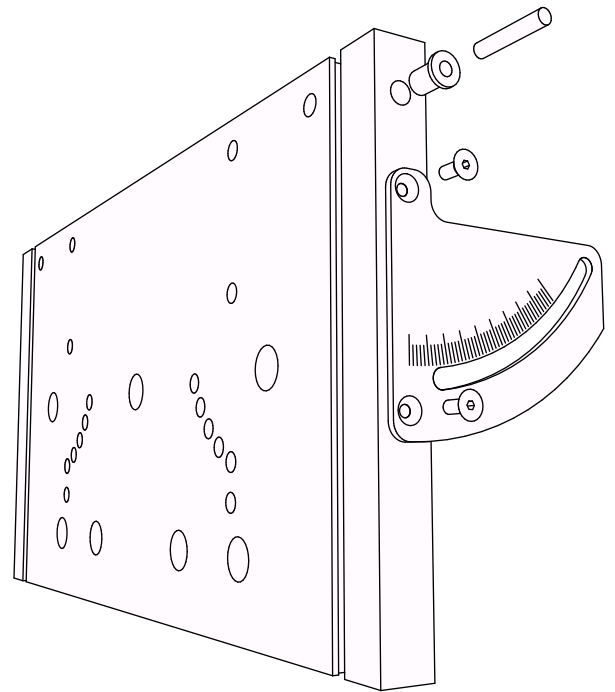

Multi-Angle Work Holder

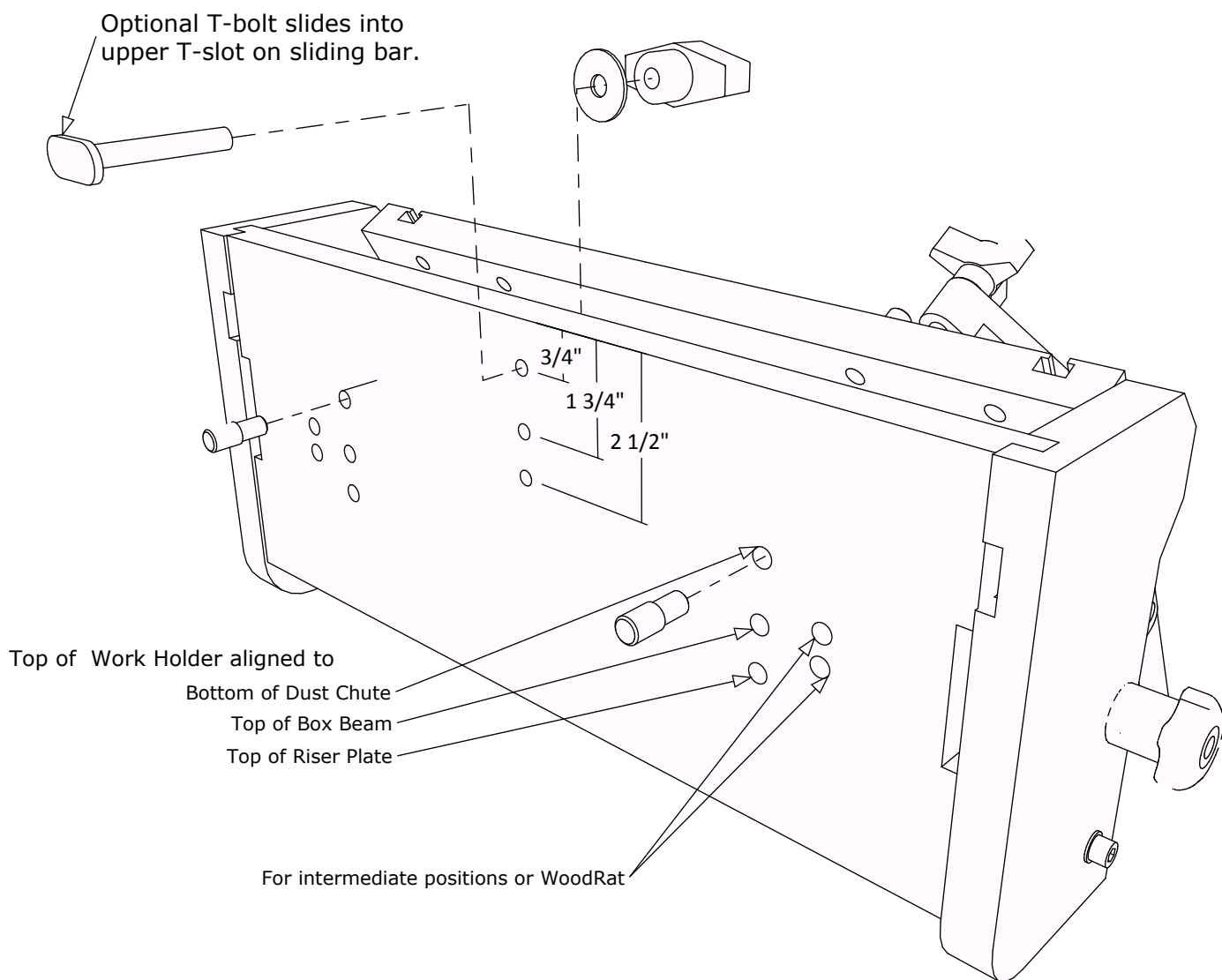

Mounting the Multi-Angle Work Holder

Insert plastic locator pins into appropriate holes on the back of the Work Holder. The pins rest on the ledge above the lower t-slot in sliding bar. The Work Holder is then clamped in place between the fixed fence and the moveable fence using the cam. It is helpful to glue a piece of fine sandpaper to the outside ends of the Work Holder to increase security in the clamp.

Optionally, you may use a T-bolt, washer and a knob to further secure the Work Holder to the sliding bar. Drill 17/64" holes as shown above. The T-bolt is inserted into upper T-slot in the sliding bar. Tighten the knob snug, but not so tight as to prevent sliding bar travel.

After installing the Multi-Angle Work Holder, square the aluminum plate to the underside of the Base Plate. Set the cam stops so you can quickly return the plate to square.



Multi-Angle Work Holder

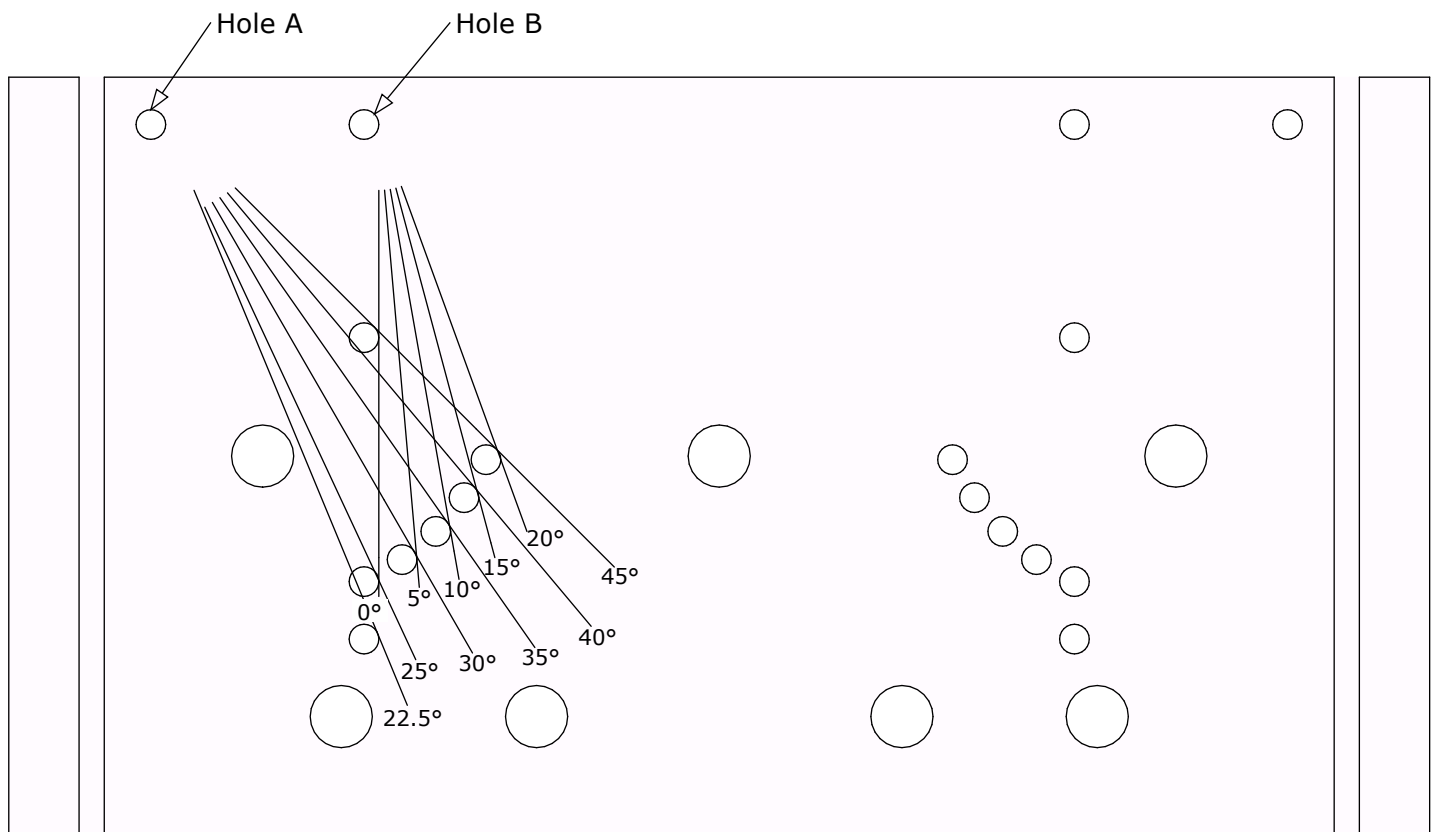

For angled placement of the work insert a pin in either Hole A or Hole B and a second pin in a lower hole for the desired angle.